

Product Fact Sheet





FILTRATION - PLASLINE SERIES

WINNOW™
FILTRATION

WINNOWN FILTRATION PLASLINE SERIES

WINNOWN TECHNOLOGY	PAGE 4
DISC FILTRATION	PAGE 5
INTEGRA-DISC	PAGE 6
TRITON-DISC	PAGE 8
ULTRA-DISC	PAGE 10
WPL-DISC	PAGE 12
WPM-DISC	PAGE 14
WPS-DISC	PAGE 16
WINNOWN SELECTION	PAGE 18
SCREEN FILTRATION	PAGE 19
INTEGRA-SCREEN	PAGE 20
TRITON-SCREEN	PAGE 22
ORION-SCREEN	PAGE 24
SUPER-SCREEN	PAGE 26
WPM-SCREEN	PAGE 28
WPS-SCREEN	PAGE 30
WPST-SCREEN	PAGE 32
WPSE-SCREEN	PAGE 34



MANUAL CLEAN FILTERS

WinnowTM Manual Clean filters provide WinnowTM filtering technology - whilst minimising capital investment. Typically, WinnowTM Manual filters are cleaned by removing the filter element, and washed down by hosing or pressure cleaning procedure. WinnowTM Manual filters are designed with minimal mechanical parts, and simple step-by-step procedures are followed for quick and easy removal of the filtering elements.



QUICK-CLEAN FILTERS

WinnowTM Quick-Clean filters are fitted with a small valve at the base of the filter that can be opened periodically to flush-out suspended solids and therefore maximise the period between manual cleans of the filtering element. Most Quick-Clean models can be fitted with optional pressure gauges for accurate monitoring of the filter element.



QUALITY ASSURANCE

WinnowTM Plaseline Series filters are manufactured in compliance with ISO 9001:2000 quality management systems.



HYDRO-SPIN

The unique WinnowTM Hydro-Spin filter design incorporates a patented inlet system which creates a rapid circular motion of the water within the filter housing. The resulting hydro-cyclone effect and a turbulent cross-flow current over the filter surface work together to substantially increase the operating time interval between filter services. Sediment particles are kept in suspension and gradually migrate to the bottom of the housing where they can be flushed by opening the manual flush valve without having to depressurize or shut the system down. Hydro-Spin Technology is available on selected Screen and Disc filters in the WinnowTM Plaseline Series.



SCREEN FILTRATION

WinnowTM Screen filters are manufactured from stainless steel and high strength polypropylene - with enhanced UV protection and high resistance to chemicals. WinnowTM Screen filters are ideal for removal of particles, grit and other suspended solids in a large range of agricultural and industrial applications. WinnowTM Screen filters are available in a wide range of filtration - ranging from 80 to 400 microns.



DISC FILTRATION

WinnowTM Disc filters are manufactured from high strength polypropylene - with enhanced UV protection and high resistance to chemicals. WinnowTM Disc filters are made up of numerous thin plastic discs that are stacked onto a telescopic core. Both sides of the discs have grooves that cross each other when piled up and tightened together. WinnowTM Disc filter elements provide greater depth filtration than screen filters - with a high capacity to retain organic and inorganic matter. WinnowTM Disc filters are easy to wash down (having a non-porous surface) and are available in 100 and 125 micron filtration.

APPLICATIONS



WinnowTM Disc filters are manufactured from high strength polypropylene - with enhanced UV protection and high resistance to chemicals. WinnowTM Disc filters are made up of numerous thin plastic discs that are stacked onto a telescopic core. Both sides of the discs have grooves that cross each other when piled up and tightened together. WinnowTM Disc filter elements provide greater depth filtration than screen filters - with a high capacity to retain organic and inorganic matter. WinnowTM Disc filters are easy to wash down (having a non-porous surface) and are available in 100 and 125 micron filtration.

INTEGRA-DISC FILTERS

Winnow™ INTEGRA-DISC is a manual cleaning disc filter constructed with a UV resistant Polyamide body and a Polypropylene Carbonate disc filter element. Winnow™ INTEGRA-DISC filters have a highly effective filtration – due to the patented Hydro-Spin technology incorporated into the inlet design - for maximum filtration efficiency, and substantial increase in operating-time intervals - between filter services. Winnow™ INTEGRA-DISC filters are available in 100 or 125 micron disc filtration, and have 3" inlet and outlet connections. A flush-valve is included as standard equipment, and optional pressure gauges can be fitted to monitor the filtering element



DIMENSIONS (mm)

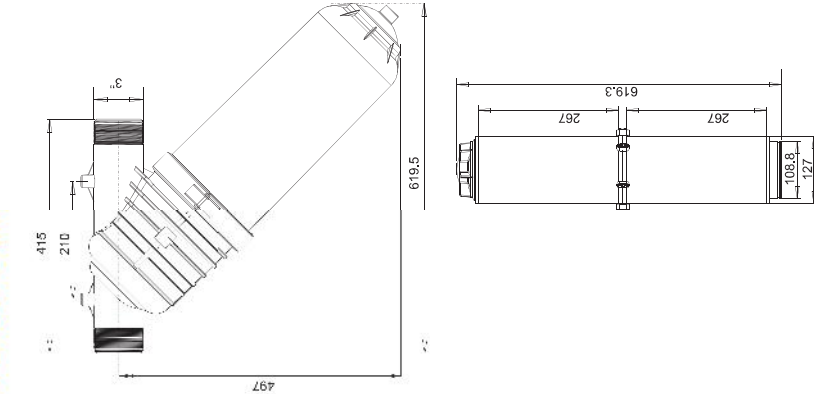

SPECIFICATIONS

MAXIMUM OPERATING PRESSURE - 10 BAR

CODE	Inlet/outlet	Disc surface cm ²	mesh	micron	Cartridge Colour	Discharge (m ³ /h) Ring position
3424/0128	3"	2133	120	125	Red	1 2 3 4
3424/0158	3"	2133	155	100	Yellow	10-25/25-40/40-55/55-70
						10-25/25-40/40-55/54-68

PRESSURE LOSS DIAGRAM

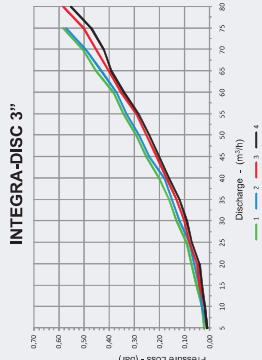

SPARE PARTS INTEGRA-DISC FILTERS

No	Code	DESCRIPTION
1	2399/0008	Filter body - INTEGRA-DISC 3"
2	1200/0005	Rubber ring - 3"
3	1266/0023	Stainless steel clamp
4	3406/0000	Hydrocyclonic system
5	1600/9535	O-ring for filtering element - 3" INTEGRA-DISC
7	3432/1208	Disc cartridge - 3" INTEGRA-DISC (120mesh)
3432/1508		Disc cartridge - 3" INTEGRA-DISC (155mesh)
8	2396/0002	Filter Bowl
9	1600/3380	O-ring for valve - 3/4"
10	3152/0202	Ball Valve M-F - 3/4"

TRITON-DISC FILTERS

Winnow™ TRITON-DISC is a manual cleaning disc filter constructed with a UV resistant Polyamide body and a Polypropylene Carbonate disc filter element. Winnow™ TRITON-DISC filters have a highly effective filtration design - due to the patented Hydro-Spin Technology incorporated into the inlet and outlet connections. A flush-valve is included as standard equipment, and optional pressure gauges can be fitted to monitor the filtering element.



DIMENSIONS (mm)

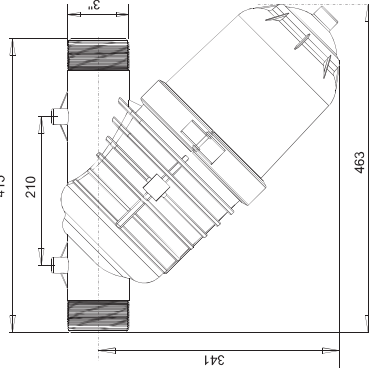

SPECIFICATIONS

MAXIMUM OPERATING PRESSURE - 10 BAR

CODE	Inlet/outlet	Disc surface cm²	mesh	micron	Cartridge Colour	Discharge (m³/h): Ring position
3423/0128	3"	1315	120	125	Red	1 2 3 4
3423/0158	3"	1315	155	100	Yellow	10-23 23-36 36-48 48-60
						10-23 23-36 36-47 47-59

PRESSURE LOSS DIAGRAM

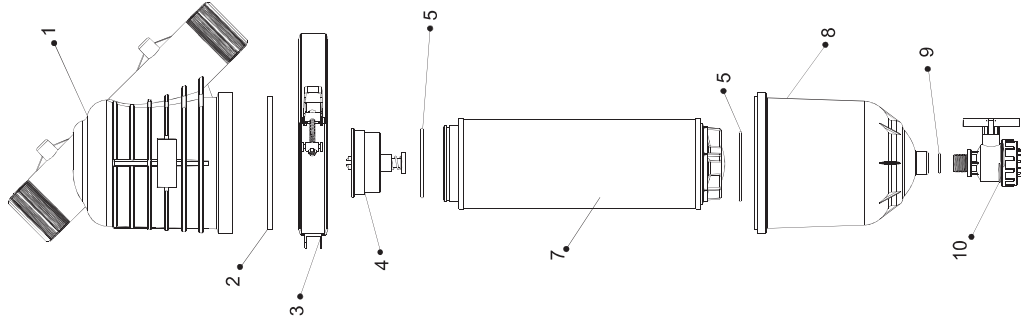
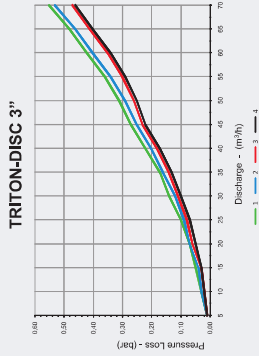

SPARE PARTS TRITON-DISC FILTERS

No	Code	DESCRIPTION
1	2399/0008	Filter body - TRITON-DISC 3"
2	1200/0005	Rubber ring - 3"
3	1206/0023	Stainless steel clamp
4	3406/0000	Hydrocyclic system
5	1600/9535	O-ring for filtering element - 3" TRITON-DISC
7	3431/1208	Disk cartridge - 3" TRITON-DISC (120mesh)
	3431/1508	Disk cartridge - 3" TRITON-DISC (155mesh)
8	2396/0001	Filter Bowl
9	1600/3380	O-ring for valve - 3/4"
10	3152/0202	Ball Valve M-F - 3/4"

ULTRA-DISC FILTERS

Winnow™ ULTRA-DISC is a manual cleaning disc filter constructed with a UV resistant Polyamide body and a Polypropylene Carbonate disc filter element. Winnow™ ULTRA-DISC filters have a highly effective filtration at a wide range of flow rates – due to the innovative Flow-Setting Ring which is a velocity regulator that allows the filter to achieve efficient hydrocyclonism – regardless of the flow. Winnow™ ULTRA-DISC filters also incorporate the patented Hydro-Spin Technology for maximum filtration efficiency, and substantial increase in operating-time intervals between filter services. Winnow™ ULTRA-DISC filters are available in 100 or 125 micron disc filtration, and have one inlet and two alternative outlets - for a versatile range of installations. 2" BSP and 3" BSP connections are available. A flush-valve is included as standard equipment, and optional pressure gauges can be fitted to monitor the filtering element.



DIMENSIONS (mm)

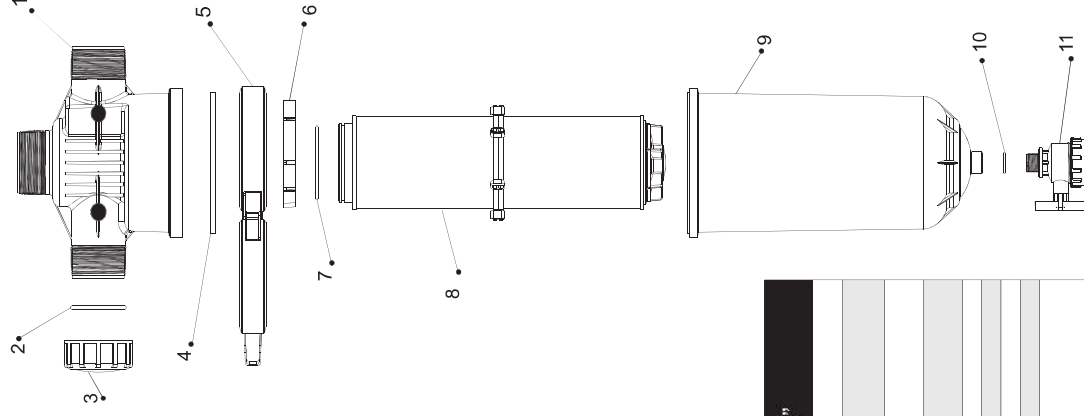
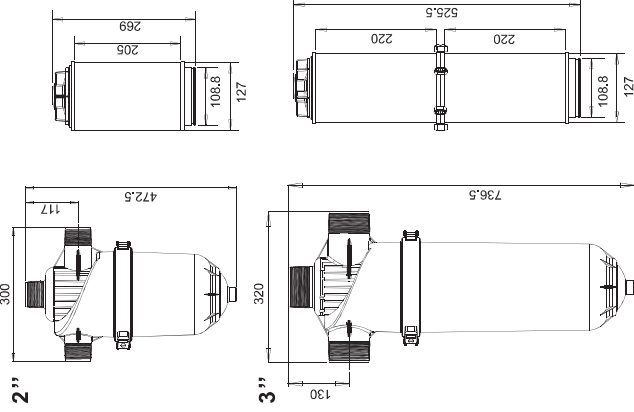

SPECIFICATIONS

MAXIMUM OPERATING PRESSURE - 10 BAR

CODE	Inlet/outlet	Disc surface cm ²	mesh	micron	Cartridge Colour	Discharge (m ³ /h)			
						1	2	3	4
3396/0126	2"	817	120	125	Red	5 - 18	18 - 24	24 - 30	30 - 35
3396/0156	2"	817	155	100	Yellow	5 - 17	17 - 23	23 - 28	28 - 33
3396/0128	3"	1755	120	125	Red	10 - 19	19 - 28	28 - 40	40 - 52
3396/0158	3"	1755	155	100	Yellow	10 - 18	18 - 27	27 - 38	38 - 50

PRESSURE LOSS DIAGRAMS

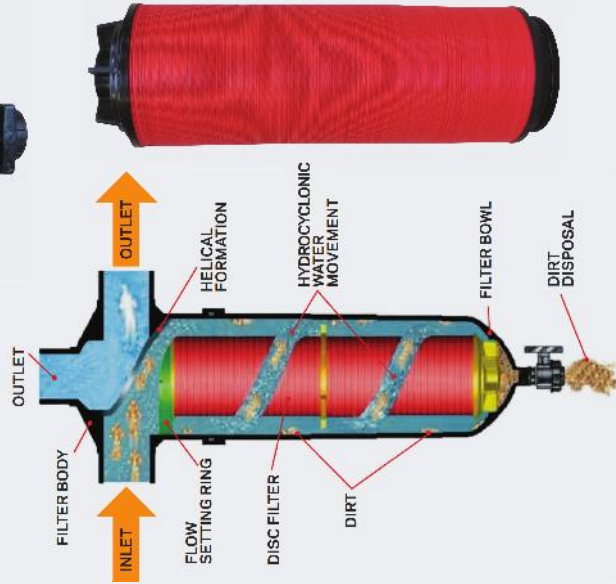
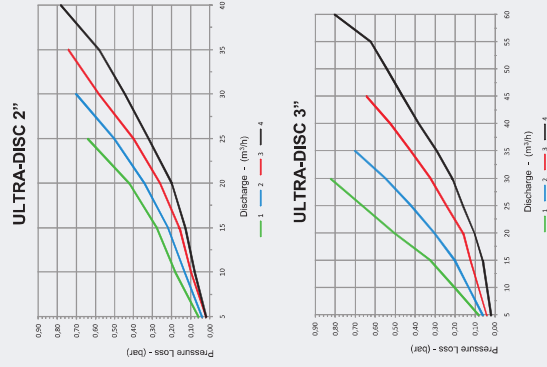

SPARE PARTS ULTRA-DISC 2" & 3"

No	Code	DESCRIPTION
1	2396/0006	Filter body - ULTRA-DISC 2"
2	2396/0008	Filter body - ULTRA-DISC 3"
3	1600/3361	O-ring female plug - 2"
4	1600/3363	O-ring female plug - 3"
5	1200/0005	Sealing ring - 2" & 3"
6	2396/0003	Flow setting ring
7	1600/9535	O-ring for disk element - 2" & 3"
8	3482/6120	Disk element - 2" ULTRA-DISC (120mesh)
9	3482/6155	Disk element - 2" ULTRA-DISC (155mesh)
10	3482/6120	Disk element - 3" ULTRA-DISC (120mesh)
11	3482/6155	Disk element - 3" ULTRA-DISC (155mesh)
12	2396/0001	Filter Bowl - ULTRA-DISC 2"
13	2396/0002	Filter Bowl - ULTRA-DISC 3"
14	1600/3380	O-ring for valve - 3/4"
15	3152/0202	Ball Valve M-F - 3/4"

WPL-DISC

WPL-DISC FILTERS

Winnow™ IL-DISC is a manual cleaning disc filter constructed with a UV resistant Polypropylene Carbonate body and disc filter element. Winnow™ IN-LINE FILTER filters are available in 100 or 125 micron disc filtration, and 1½" BSP, 2" BSP and 3" BSP connections are available. Optional pressure gauges can be fitted to monitor the filtering element.



DIMENSIONS (mm)

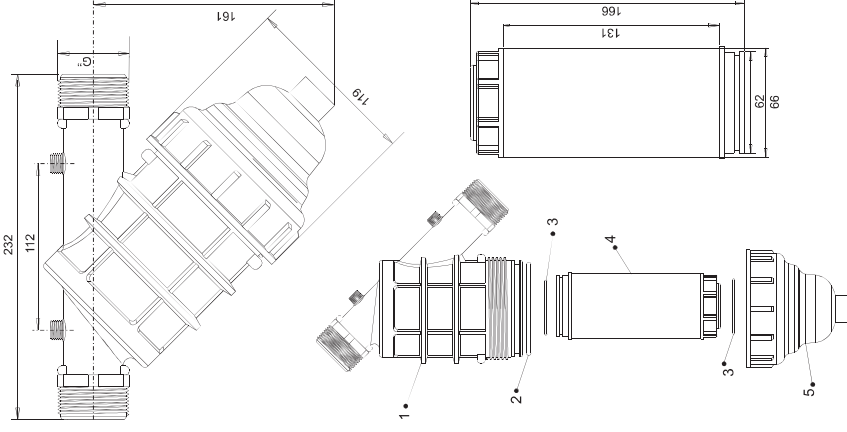

WPL-DISC

SPECIFICATIONS

MAXIMUM OPERATING PRESSURE - 8 BAR

CODE	Inlet/outlet	Screen surface cm²	mesh	micron	Cartridge Colour	Discharge (m³/h)
3394/0125	1½"	281	120	125	Red	14
3394/0155	1½"	281	155	100	Yellow	14
3394/0126	2"	404	120	125	Red	20
3394/0156	2"	404	155	100	Yellow	20

PRESSURE LOSS DIAGRAM

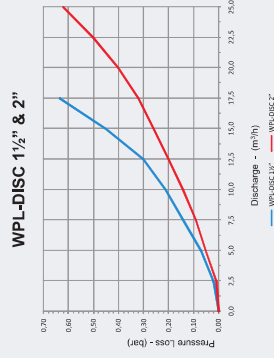

SPARE PARTS WPL-DISC FILTERS 1 ½"

No	Code	DESCRIPTION
1	2382/0005	WPL-DISC disk filter body - 1½"
2	1600/3485	O-ring for filter body
3	1600/3450	O-ring for screen element/disk cartridge
4	3484/1205	Disk cartridge - 1½" (● 120mesh)
4	3484/1555	Disk cartridge - 1½" (● 155mesh)
5	2395/0005	Filter Bowl - 1½"

SPARE PARTS WPL-DISC FILTERS 2"

No	Code	DESCRIPTION
1	2382/0006	WPL-DISC filter body - 2"
2	1600/3410	O-ring for filter body
3	1600/3469	O-ring for screen element/disk cartridge
4	3484/1206	Disk cartridge - 2" (● 120mesh)
4	3484/1556	Disk cartridge - 2" (● 155mesh)
5	2395/0006	Filter Bowl - 2"

WPM-DISC FILTERS

Winnow™ ILS-DISC is a manual cleaning disc filter constructed with a UV resistant Polypropylene Carbonate body and disc filter element. Winnow™ ILS-DISC filters are available in 125 micron disc filtration, and 1" BSP and 1 1/4" BSP connections are available. A flush-valve is included as standard equipment, and optional pressure gauges can be fitted to monitor the filtering element.



DIMENSIONS (mm)

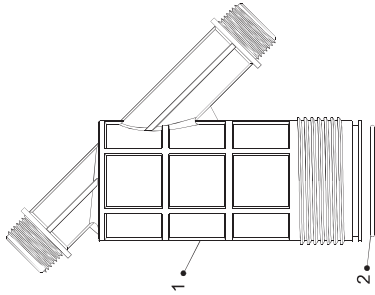
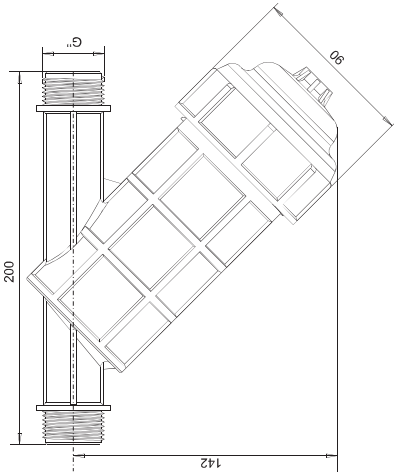

SPECIFICATIONS

MAXIMUM OPERATING PRESSURE - 6 BAR

CODE	Inlet/outlet	Screen surface cm ²	mesh	micron	Cartridge Colour	Discharge (m ³ /h)
3386/0122	1"	199	120	125	Green	6
3386/0123	1 1/4"	199	120	125	Green	6

PRESSURE LOSS DIAGRAMS

WPM-DISC 1" & 1 1/4"

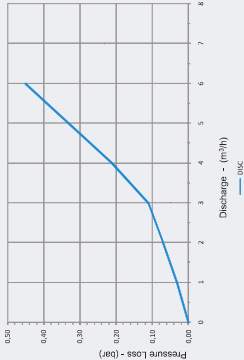

SPARE PARTS WPM-DISC FILTERS

No	Code	DESCRIPTION
1	2386/0303 2386/0404	WPM-DISC filter body - 1" WPM-DISC filter body - 1 1/4"
2	1600/3385	O-ring for WPM filter body
3	1600/3384	O-ring for WPM screen element/disc cartridge
4	4492/3242	WPM-DISC cartridge - (120mesh)
5	2380/0000	Filter Bowl

WPS-DISC FILTERS

Winnow™ IN-LINE FILTER LARGE is a manual cleaning disc filter constructed with a UV resistant Polypropylene Carbonate body and disc filter element. Winnow™ IN-LINE FILTER LARGE filters are available in 100 or 125 micron disc filtration of 1" BSP models and 125 micron only for 3/4" BSP models.



SPECIFICATIONS

MAXIMUM OPERATING PRESSURE - 6 BAR

CODE	Inlet/outlet	Screen surface cm ²	mesh	micron	Cartridge Colour	Discharge (m ³ /h)
3383/0122	3/4"	152	120	125	Red	4
3383/0123	1"	152	120	125	Red	5
3383/0153	1"	152	155	100	Black	5

PRESSURE LOSS DIAGRAMS

WPS-DISC 3/4"

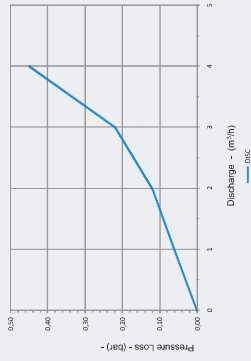

WPS-DISC 1"

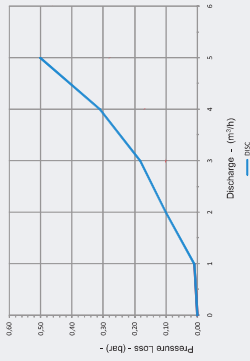

DIMENSIONS (mm)

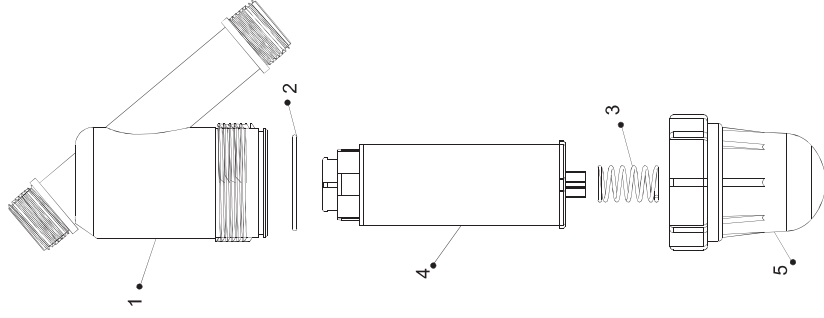
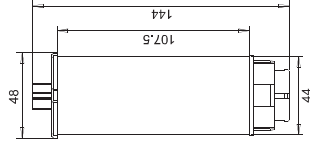
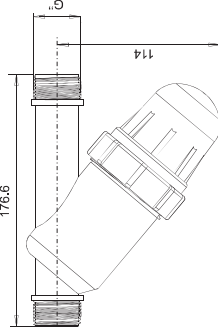

SPARE PARTS WPS-DISC FILTERS

No	Code	DESCRIPTION
1	2382/0002	WPS-DISC filter body 3/4"
	2382/0003	WPS-DISC filter body 1"
2	1600/3450	O-ring for filter body
3	1388/0000	Spring for disk cartridge
	3482/2242	Disk cartridge - (120mesh)
	3482/2542	Disk cartridge - (155mesh)
5	2394/0000	Filter Bowl

SELECTING A WINNOWNTM PLASLINE FILTER



DISC OR SCREEN FILTRATION ELEMENT?

Water which contains solid particles (e.g. bore and most town water) both screen and disc filter elements are can be used. Water containing inorganic particles (e.g. canals and dams) only disc filters are recommended – due to their better filtration depth. Screen & Disc filters with Hydro-Spin Technology offer prolonged filter obstruction - resulting in substantially reduced need for manual filter cleaning intervals, and therefore maintaining maximum efficiency in your entire irrigation system - regardless of the filter element selection.



FILTRATION SELECTION - WHICH MICRON?

SPRAY IRRIGATION APPLICATIONS

In the case of inorganic particles (e.g. sand), the proposed size of filtration should be at least equal to half the diameter of the nozzle on the irrigation device - in order to prevent clogging. In the case of organic particles - filtration size and depth is more critical because these particles may pass from the cleaning element - as they decompose. In this case the filtration size should be no larger than the one third of the nozzle size on the irrigation device.



DRIP IRRIGATION APPLICATIONS

In drip irrigation systems where the irrigation discharge holes are generally 1.0mm diameter or less - the size of the filter element should be 125 micron or smaller. If the water supply has excessive suspended solid levels - a multi-stage filtration system may be required.

SCREEN FILTRATION



WinnowTM Screen filters are manufactured from stainless steel and high strength polypropylene - with enhanced UV protection and high resistance to chemicals. WinnowTM Screen filters are ideal for removal of particles, grit and other suspended solids in a large range of agricultural and industrial applications. WinnowTM Screen filters are available in a wide range of filtration - ranging from 80 to 400 microns.

INTEGRA-SCREEN FILTERS

Winnow™ INTEGRA-SCREEN is a manual cleaning screen filter constructed with a UV resistant Polyamide body, and a stainless steel screen filter element with a Polypropylene Carbonate casing for superior strength and chemical resistance. Winnow™ INTEGRA-SCREEN filters have a highly effective filtration - due to the patented Hydro-Spin Technology incorporated into the inlet design - for maximum filtration efficiency, and substantial increase in operating-time intervals between filter services. Winnow™ INTEGRA-SCREEN filtration ranges from 85 to 400 micron, and has 3" BSP inlet and outlet connections. A flush-valve is included as standard equipment, and optional pressure gauges can be fitted to monitor the filtering element.



DIMENSIONS (mm)

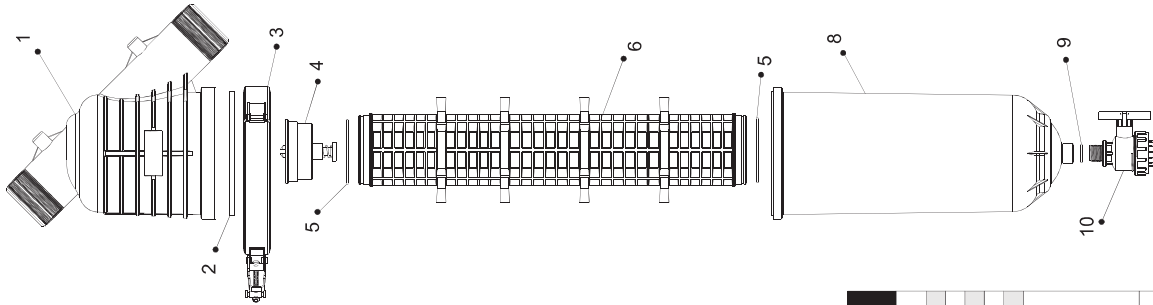
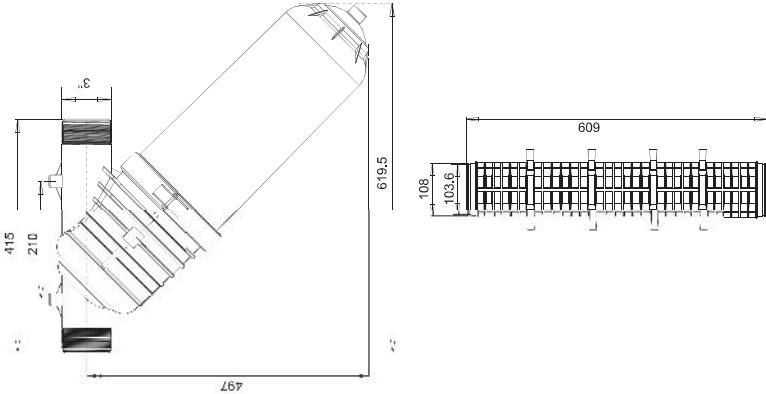

SPARE PARTS INTEGRA-SCREEN FILTERS

No	Code	DESCRIPTION
1	2399/0008	Filter body - INTEGRA-SCREEN 3"
2	1200/0005	Rubber ring - 3"
3	1206/0023	Stainless steel clamp
4	3406/0000	Hydrodynamic system
5	1600/9535	O-ring for filtering element - 3" INTEGRA-SCREEN
	3481/3040	Screen element - 3" INTEGRA-SCREEN (40mesh)
	3481/3060	Screen element - 3" INTEGRA-SCREEN (60mesh)
6	3481/3080	Screen element - 3" INTEGRA-SCREEN (80mesh)
	3481/3120	Screen element - 3" INTEGRA-SCREEN (120mesh)
	3481/3153	Screen element - 3" INTEGRA-SCREEN (150mesh)
	3481/3180	Screen element - 3" INTEGRA-SCREEN (180mesh)
8	2396/0002	Filter Bowl
9	1600/3380	O-ring for valve - 3/4"
10	3152/0202	Ball Valve M-F - 3/4"

SPECIFICATIONS

MAXIMUM OPERATING PRESSURE - 10 BAR

CODE	Inlet/outlet	Screen surface cm²	mesh	micron	Cartridge Colour	Discharge (m³/h)
3409/0048	3"	778	40	400	Blue	60
3409/0068	3"	778	60	250	Grey	60
3409/0088	3"	778	80	200	Black	60
3409/0128	3"	778	120	125	Red	60
3409/0158	3"	778	150	100	Brown	60
3409/0188	3"	778	180	85	Yellow	60

PRESSURE LOSS DIAGRAM

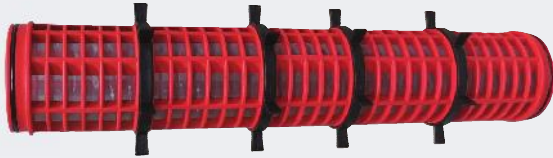
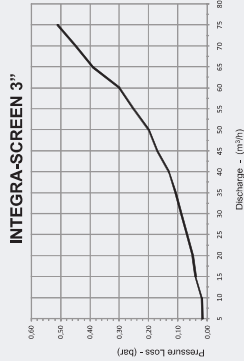

TRITON-SCREEN FILTERS

Winnow™ TRITON-SCREEN is a manual cleaning screen filter constructed with a UV resistant Polyamide body, and a stainless steel screen filter element with a Polypropylene Carbonate casing for superior strength and chemical resistance. Winnow™ TRITON-SCREEN filters have a highly effective filtration - due to the patented Hydro-Spin Technology incorporated into the inlet design - for maximum filtration efficiency, and substantial increase in operating-time intervals between filter services. Winnow™ TRITON-SCREEN filtration ranges from 85 to 400 micron, and has 3" BSP inlet and outlet connections. A flush-valve is included as standard equipment, and optional pressure gauges can be fitted to monitor the filtering element.



DIMENSIONS (mm)

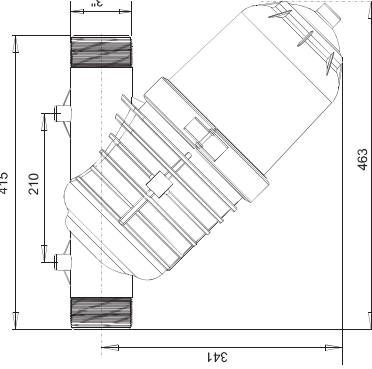

SPECIFICATIONS

MAXIMUM OPERATING PRESSURE - 10 BAR

CODE	Inlet/outlet	Screen surface cm ²	mesh	micron	Cartridge Colour	Discharge (m ³ /h)
3408/0048	3"	479	40	400	Blue	60
3408/0068	3"	479	60	250	Grey	60
3408/0088	3"	479	80	200	Black	60
3408/0128	3"	479	120	125	Red	60
3408/0158	3"	479	150	100	Brown	60
3408/0188	3"	479	180	85	Yellow	60

PRESSURE LOSS DIAGRAM

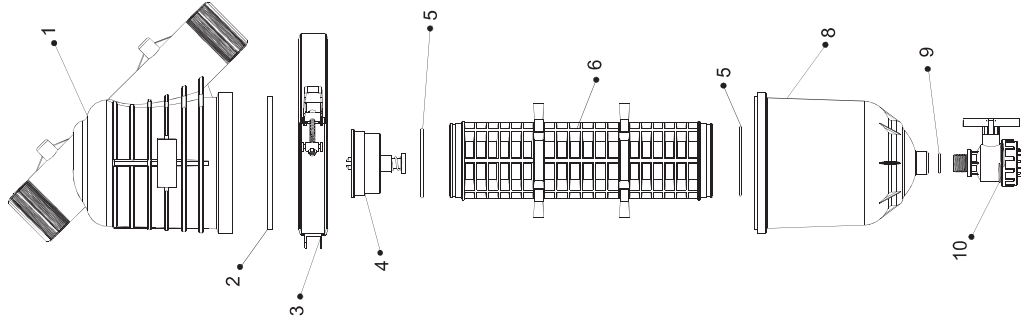
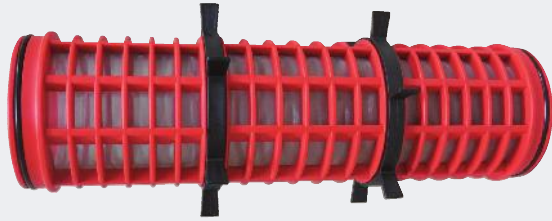
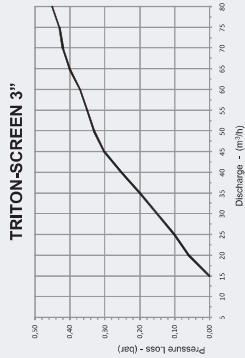

SPARE PARTS TRITON-SCREEN FILTERS

No	Code	DESCRIPTION
1	2399/0008	Filter body - TRITON-SCREEN 3"
2	1200/0005	Rubber ring - 3"
3	1206/0023	Stainless steel clamp
4	3406/0000	Hydrocyclic system
5	1600/9535	O-ring for filtering element - 3" TRITON-SCREEN
6	3481/9040	Screen element - 3" TRITON-SCREEN (40mesh)
	3481/9060	Screen element - 3" TRITON-SCREEN (60mesh)
	3481/9080	Screen element - 3" TRITON-SCREEN (80mesh)
	3481/9120	Screen element - 3" TRITON-SCREEN (120mesh)
	3481/9150	Screen element - 3" TRITON-SCREEN (150mesh)
	3481/9180	Screen element - 3" TRITON-SCREEN (180mesh)
8	2396/0001	Filter Bowl
9	1600/3380	O-ring for valve - 3/4"
10	3152/0202	Ball Valve M-F - 3/4"

ORION-SCREEN FILTERS

Winnow™ ORION is a manual cleaning screen filter constructed with a UV resistant Polyamide body, and a stainless steel screen filter element with a Polypropylene Carbonate casing for superior strength and chemical resistance. Winnow™ ORION filters have a highly effective filtration - due to the patented Hydro-Spin Technology incorporated into the inlet design - for maximum filtration efficiency, and substantial increase in operating-time intervals between filter services. Winnow™ ORION filtration ranges from 85 to 400 micron, and have one inlet and two alternative outlets - for a versatile range of installations. 2" BSP and 3" BSP connections are available. A flush-valve is included as standard equipment, and optional pressure gauges can be fitted to monitor the filtering element.



SPECIFICATIONS

MAXIMUM OPERATING PRESSURE - 10 BAR

CODE	Inlet/outlet	Screen surface cm ²	mesh	micron	Cartridge Colour	Discharge (m ³ /h)
3407/0046	2"	304	40	400	Blue	40
3407/0066	2"	304	60	250	Grey	40
3407/0086	2"	304	80	200	Black	40
3407/0126	2"	304	120	125	Red	40
3407/0150	2"	304	150	100	Brown	40
3407/0186	2"	304	180	85	Yellow	40
3407/0048	3"	654	40	400	Blue	50
3407/0068	3"	654	60	250	Grey	50
3407/0088	3"	654	80	200	Black	50
3407/0128	3"	654	120	125	Red	50
3407/0158	3"	654	150	100	Brown	50
3407/0188	3"	654	180	85	Yellow	50

PRESSURE LOSS DIAGRAM

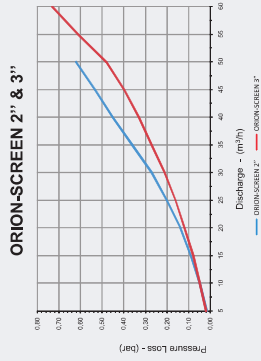

DIMENSIONS (mm)

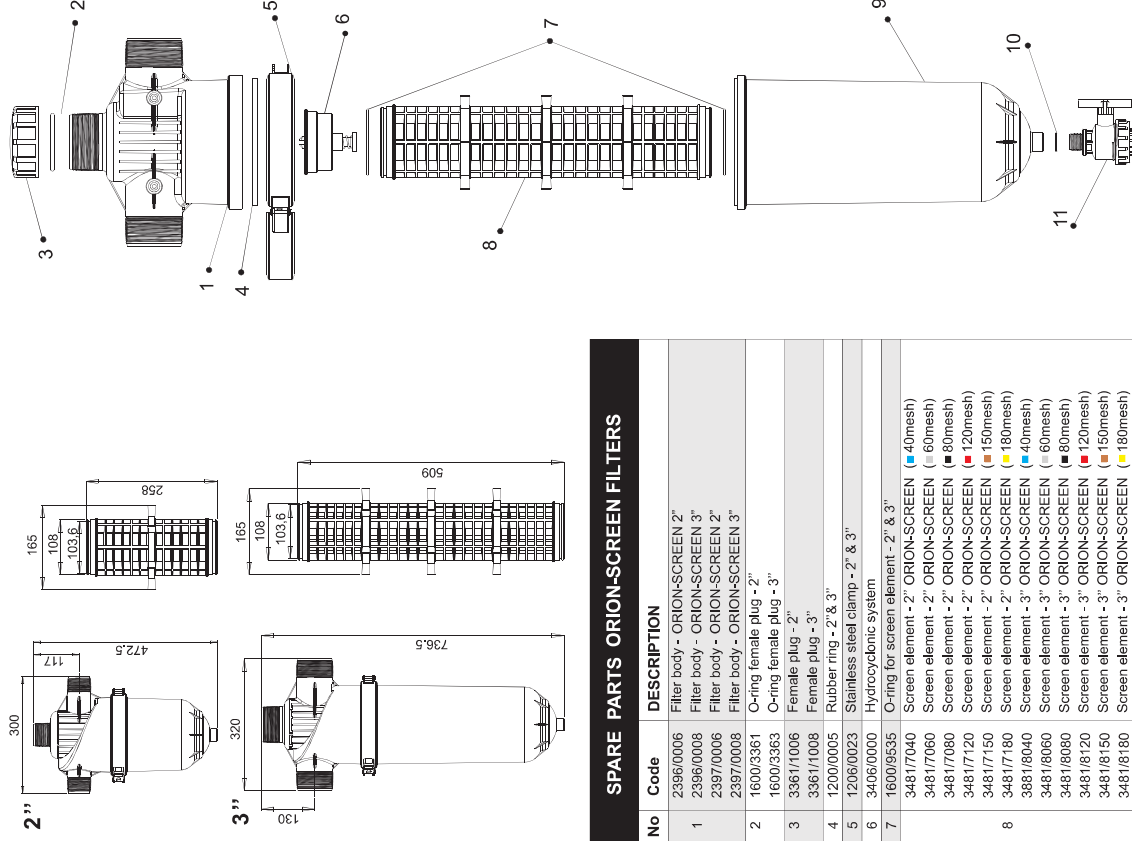

SPARE PARTS ORION-SCREEN FILTERS

No	Code	DESCRIPTION
1	2396/0006	Filter body - ORION-SCREEN 2"
	2396/0008	Filter body - ORION-SCREEN 3"
	2397/0006	Filter body - ORION-SCREEN 2"
	2397/0008	Filter body - ORION-SCREEN 3"
2	1600/3361	O-ring female plug - 2"
	1600/3363	Female plug - 2"
3	3361/1006	Female plug - 3"
	3361/1008	Female plug - 3"
4	1200/0005	Rubber ring - 2" & 3"
5	1206/0023	Stainless steel clamp - 2" & 3"
6	3406/0000	Hydrocyclic system
7	1600/9535	O-ring for screen element - 2" & 3"
	3481/7040	Screen element - 2" ORION-SCREEN (40mesh)
	3481/7060	Screen element - 2" ORION-SCREEN (60mesh)
	3481/7080	Screen element - 2" ORION-SCREEN (80mesh)
	3481/7120	Screen element - 2" ORION-SCREEN (120mesh)
	3481/7150	Screen element - 2" ORION-SCREEN (150mesh)
8	3481/7180	Screen element - 2" ORION-SCREEN (180mesh)
	3881/8040	Screen element - 3" ORION-SCREEN (40mesh)
	3481/8060	Screen element - 3" ORION-SCREEN (60mesh)
	3481/8080	Screen element - 3" ORION-SCREEN (80mesh)
	3481/8120	Screen element - 3" ORION-SCREEN (120mesh)
	3481/8150	Screen element - 3" ORION-SCREEN (150mesh)
	3481/8180	Screen element - 3" ORION-SCREEN (180mesh)
9	2396/0001	Filter Bowl - ORION-SCREEN 2"
	2396/0002	Filter Bowl - ORION-SCREEN 3"
10	1600/3380	O-ring for valve - 3/4"
11	3152/0202	Ball Valve M-F - 3/4"

SUPER-SCREEN

SUPER-SCREEN FILTERS

Winnow™ SUPER-SCREEN is a manual cleaning screen filter constructed with a UV resistant Polypropylene Carbonate body, and a stainless steel screen filter element with a Polypropylene Carbonate casing for superior strength and chemical resistance. Winnow™ SUPER-SCREEN filters have a highly effective filtration – due to the patented Hydro-Spin Technology incorporated into the inlet design – for maximum filtration efficiency, and substantial increase in operating-time intervals between filter services. Winnow™ SUPER-SCREEN filtration ranges from 1.00 to 250 micron. 1½" BSP and 2" BSP connections are available. A flush-valve is included as standard equipment, and optional pressure gauges can be fitted to monitor the filtering element.



DIMENSIONS (mm)

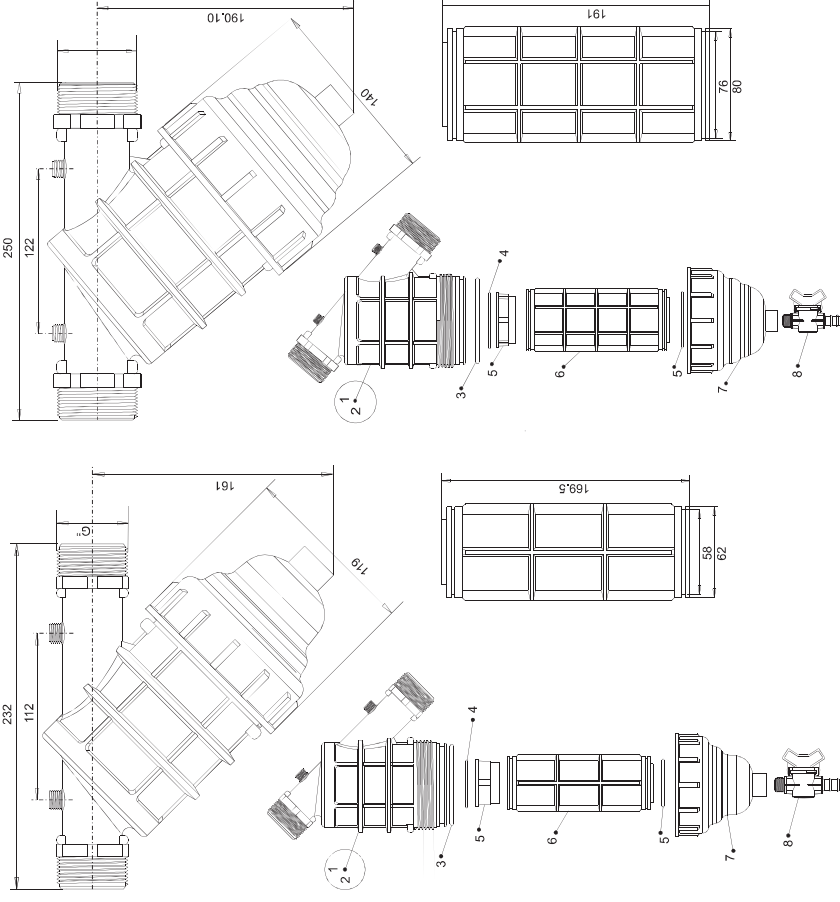

SPECIFICATIONS

MAXIMUM OPERATING PRESSURE - 8 BAR

CODE	Inlet/outlet	Screen surface cm ²	mesh	micron	Cartridge Colour	Discharge (m ³ /h)
3388/0065	1½"	185	60	250	Grey	8
3388/0085	1½"	185	80	200	Black	8
3388/0125	1½"	185	120	125	Red	8
3388/0155	1½"	185	150	100	Brown	8
3388/0066	2"	274	60	250	Grey	16
3388/0086	2"	274	80	200	Black	16
3387/0126	2"	274	120	125	Red	16
3387/0156	2"	274	150	100	Brown	16

PRESSURE LOSS DIAGRAM

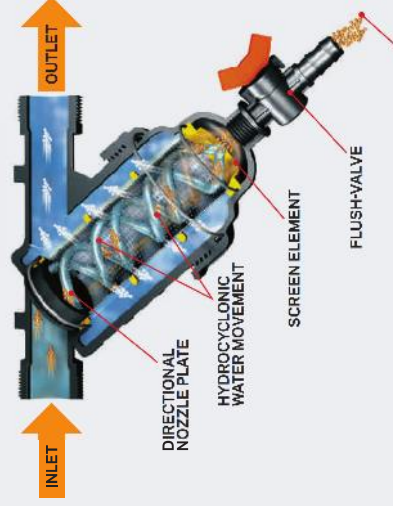
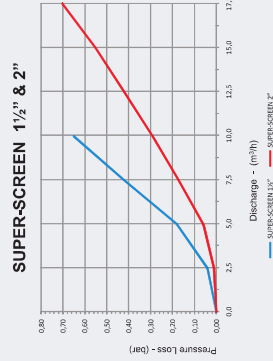

RELEASE OF DIRT AND SUSPENDED SOLIDS

SPARE PARTS SUPER-SCREEN FILTERS 1 ½"

No	Code	DESCRIPTION
1	2387/0005	SUPER-SCREEN filter body - 1½"
2	2389/0005	SUPER-SCREEN hydrocyclonic screen filter body - 1½"
3	1600/3485	O-ring for filter body
4	1600/3450	O-ring for screen element/disk cartridge
5	2388/0005	Hydrocyclonic plate - 1½"
6	3481/5080	Screen element - 1½" (■ 60mesh)
7	3481/5120	Screen element - 1½" (■ 120mesh)
8	2395/0005	Screen element - 1½" (■ 150mesh)
8	3161/0116	Filter Bowl - 1½"

SPARE PARTS SUPER-SCREEN FILTERS 2"

No	Code	DESCRIPTION
1	2387/0006	SUPER-SCREEN filter body - 2"
2	2389/0006	SUPER-SCREEN hydrocyclonic screen filter body - 2"
3	1600/3410	O-ring for filter body
4	1600/3469	O-ring for screen element/disk cartridge
5	2388/0006	Hydrocyclonic plate - 2"
6	3481/6060	Screen element - 2" (■ 60mesh)
7	3481/6080	Screen element - 2" (■ 80mesh)
8	3481/6120	Screen element - 2" (■ 120mesh)
9	3481/6150	Screen element - 2" (■ 150mesh)
7	2395/0006	Filter Bowl - 2"
8	3161/0116	Mini valve threaded/indented - 1½" X Ø16

WPM-SCREEN

WPM-SCREEN FILTERS

Winnow™ ILS-SCREEN is a manual cleaning screen filter constructed with a UV resistant Polypropylene Carbonate body, and a stainless steel screen filter element with a Polypropylene Carbonate casing for superior strength and chemical resistance. Winnow™ ILS-SCREEN filtration ranges from 80 to 200 micron, and 1" BSP and 1½" BSP connections are available. A flush-valve is included as standard equipment.



DIMENSIONS (mm)

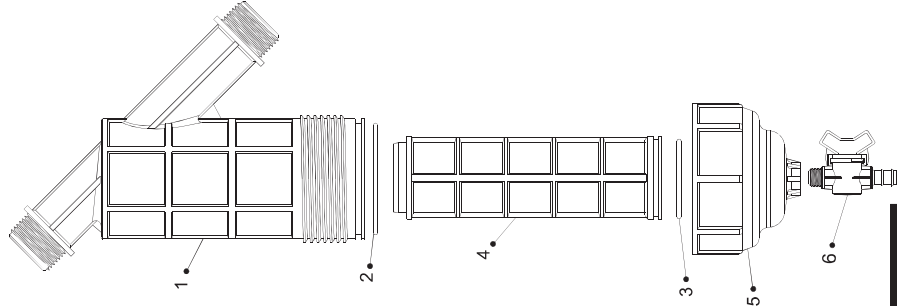
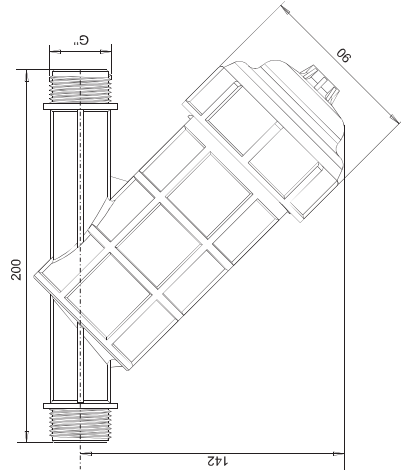

SPECIFICATIONS

MAXIMUM OPERATING PRESSURE - 6 BAR

CODE	Inlet/outlet	Screen surface cm ²	mesh	micron	Cartridge Colour	Discharge (m ³ /h)
3384/0083	1"	152	80	200	Black	8
3384/0123	1"	152	120	125	Red	8
3384/0153	1"	152	150	100	Brown	8
3384/0183	1"	152	180	85	Yellow	8
3384/0084	1½"	152	80	200	Black	8
3384/0124	1½"	152	120	125	Red	8
3384/0154	1½"	152	150	100	Brown	8
3384/0184	1½"	152	180	85	Yellow	8

PRESSURE LOSS DIAGRAMS

WPM-SCREEN 1" & 1½"

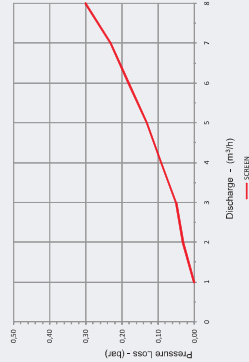

SPARE PARTS WPM-SCREEN FILTERS

No	Code	DESCRIPTION
1	2384/0033	WPM-SCREEN filter body - 1"
	2384/0044	WPM-SCREEN filter body - 1½"
2	1600/3385	O-ring for WPM filter body
3	1600/3384	O-ring for WPM screen element/disc cartridge
	3481/2080	WPM-SCREEN element - (■ 80mesh)
4	3481/2120	WPM-SCREEN element - (■ 120mesh)
	3481/2150	WPM-SCREEN element - (■ 150mesh)
	3481/2180	WPM-SCREEN element - (■ 180mesh)
5	2380/0000	Filter Bowl
6	3161/0016	Mini valve threaded/indented (optional) - 3/8" X Ø16

WPS-SCREEN FILTERS

Winnow™ ILL-SCREEN is a manual cleaning screen filter constructed with a UV resistant Polypropylene Carbonate body, and a stainless steel screen filter element with a Polypropylene Carbonate casing for superior strength and chemical resistance. Winnow™ ILL-SCREEN filtration ranges from 100 to 400 micron for 1" BSP models and 125 to 400 micron for 3/4" BSP models.



SPECIFICATIONS

MAXIMUM OPERATING PRESSURE - 6 BAR

CODE	Inlet/outlet	Screen surface cm ²	mesh	micron	Cartridge Colour	Discharge (m ³ /h)
3382/0042	3/4"	90	40	400	Blue	5
3382/0062	3/4"	90	60	250	Grey	5
3382/0082	3/4"	90	80	200	Black	5
3382/0122	3/4"	90	120	125	Red	5
3382/0043	1"	90	40	400	Blue	6
3382/0063	1"	90	60	250	Grey	6
3382/0083	1"	90	80	200	Black	6
3382/0123	1"	90	120	125	Red	6
3382/0153	1"	90	150	100	Brown	6

PRESSURE LOSS DIAGRAMS

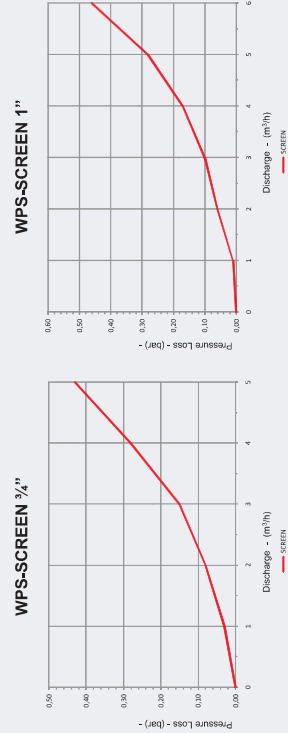

DIMENSIONS (mm)

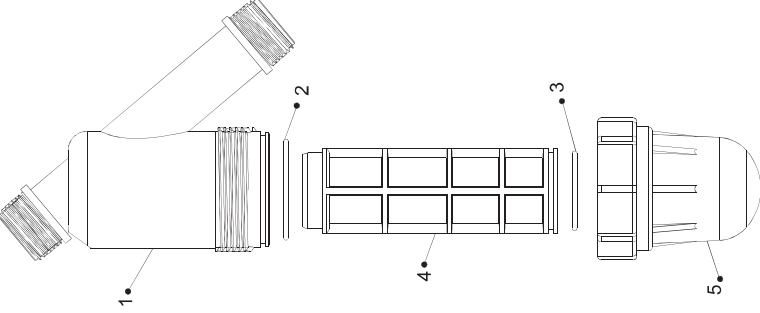
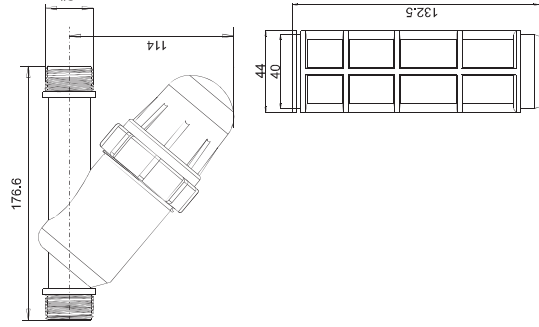

No	Code	DESCRIPTION
1	2372/0002	WPS-SCREEN filter body - 3/4"
2	2372/0003	WPS-SCREEN filter body - 1"
3	1600/3450	O-ring for filter body
4	1600/3382	O-ring for screen element
5	3481/1040	Screen element - (40mesh)
6	3481/1060	Screen element - (60mesh)
7	3481/1080	Screen element - (80mesh)
8	3481/1120	Screen element - (120mesh)
9	3481/1150	Screen element - (150mesh)
10	2394/0000	Filter Bowl

WPST-SCREEN FILTERS

Winnow™ ILL-TEE is a manual cleaning screen filter constructed with a UV resistant Polypropylene Carbonate body, and a stainless steel screen filter element with a superior strength and chemical resistance. Winnow™ ILL-TEE filtration ranges from 100 to 400 micron, and available with ¾" BSP, 1" BSP and 1½" BSP connections. Winnow™ ILL-TEE have one inlet and two alternative outlets – to suit a versatile range of installations.



SPECIFICATIONS

MAXIMUM OPERATING PRESSURE - 6 BAR

Description	Inlet/outlet/inlet	Screen surface cm²	mesh	Discharge m³/h
WPST-SCREEN connection Large 3486	¾" X 1" X ¾"	90	40 - 60 - 80 - 120 - 150	7
	1" X 1" X 1"	90	40 - 60 - 80 - 120 - 150	7
	1½" X 1" X 1½"	90	40 - 60 - 80 - 120 - 150	7

PRESSURE LOSS DIAGRAM

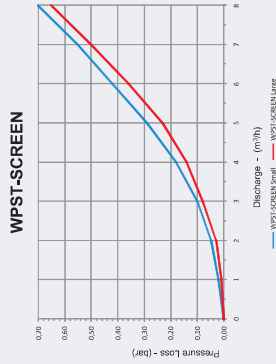

DIMENSIONS (mm)

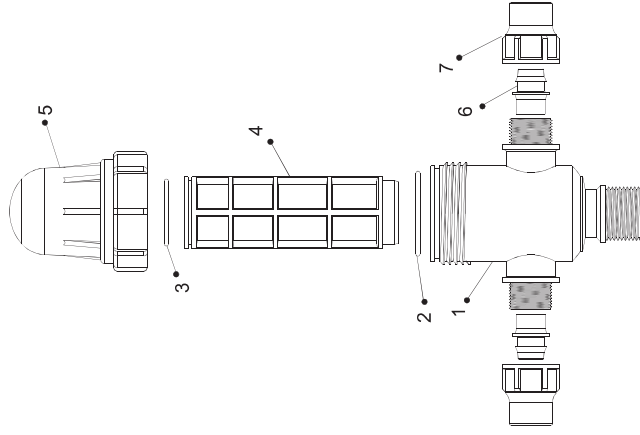
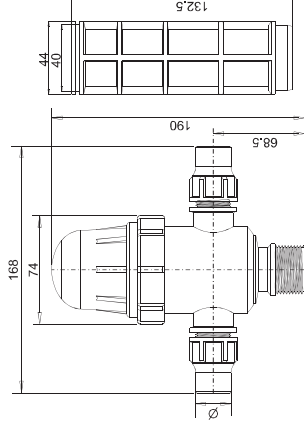

SPARE PARTS WPST-SCREEN FILTERS

No	Code	DESCRIPTION
1	2576/0222	WPST-SCREEN connection screen filter body - ¾" X ¾" X ¾"
	2576/0232	WPST-SCREEN connection screen filter body - ¾" X 1" X 1"
	2576/0333	WPST-SCREEN connection screen filter body - 1" X 1" X 1"
	2576/0434	WPST-SCREEN connection screen filter body - 1½" X 1" X 1½"
2	2576/0434	WPST-SCREEN connection screen filter body - 1½" X 1" X 1½"
	2576/0444	WPST-SCREEN connection screen filter body - 1½" X 1" X 1½"
3	1600/3450	O-ring for filter body
	1600/3382	O-ring for screen element
4	3481/1040	Screen element - (■ 40mesh)
	3481/1060	Screen element - (■ 60mesh)
	3481/1080	Screen element - (■ 80mesh)
	3481/1120	Screen element - (■ 120mesh)
5	3481/1150	Screen element - (■ 150mesh)
	3481/1180	Screen element - (■ 810mesh)
6	2231/0000	Filter Bowl
	2231/0016	Grip ring for Lock - Ø16
7	2231/0020	Grip ring for Lock - Ø20
	2231/0025	Grip ring for Lock - Ø25
7	2241/0162	Coupling nut for Lock - Ø16
	2241/0202	Coupling nut for Lock - Ø20
7	2241/0253	Coupling nut for Lock - Ø25
	2241/0322	Coupling nut for Lock - Ø32

WPSE-SCREEN FILTERS

Winnow™ ILL-ELBOW is a manual cleaning screen filter constructed with a UV resistant Polypropylene Carbonate body, and a stainless steel screen filter element with a Polypropylene Carbonate casing for superior strength and chemical resistance. Winnow™ ILL-ELBOW filtration ranges from 125 to 400 micron, and available with 1" BSP and 1/4" BSP connections.



DIMENSIONS (mm)

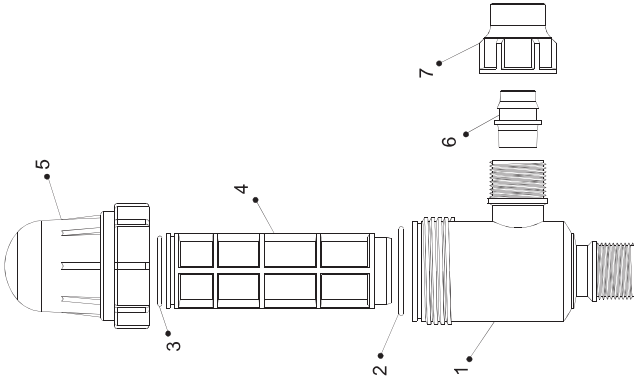
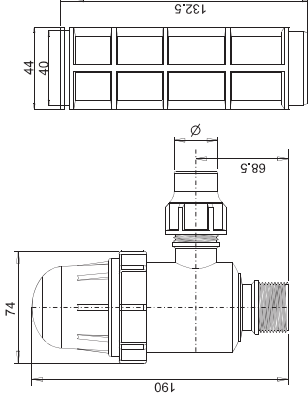

SPECIFICATIONS

MAXIMUM OPERATING PRESSURE - 6 BAR

Description	Inlet/outlet/inlet	Screen surface cm ²	mesh	Discharge m ³ /h
WPSE-SCREEN connection Small 3390	1" X 20	55	40 - 60 - 80	7
	1" X 25	55	40 - 60 - 80	7
	1" X 32	55	40 - 60 - 80	7
WPSE-SCREEN connection Large 3391	1" X 20	90	40 - 60 - 80	7
	1" X 32	90	40 - 60 - 80	7

PRESSURE LOSS DIAGRAM

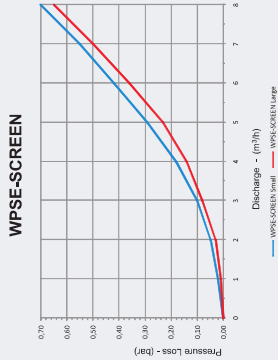

SPARE PARTS WPSE-SCREEN FILTERS

No	Code	DESCRIPTION
1	2390/0203	WPSE-SCREEN connection screen filter body - 3/4" X 1"
	2390/0303	WPSE-SCREEN connection screen filter body - 1" X 1"
	2390/0403	WPSE-SCREEN connection screen filter body - 1 1/4" X 1"
2	1600/3450	O-ring for filter body
3	1600/3382	O-ring for screen element small/large
4	3481/1040	Screen element - (40mesh)
	3481/1060	Screen element - (60mesh)
	3481/1080	Screen element - (80mesh)
	3481/1120	Screen element - (210mesh)
	3481/1150	Screen element - (510mesh)
	3481/1180	Screen element - (810mesh)
5	2394/0000	Filler Bowl
6	2231/0016	Grip ring for Lock - Φ16
	2231/0020	Grip ring for Lock - Φ20
	2331/0025	Grip ring for Lock - Φ25
	2331/0030	Grip ring for Lock - Φ32
7	2241/0162	Coupling nut for Lock - Φ16
	2241/0202	Coupling nut for Lock - Φ20
	2241/0253	Coupling nut for Lock - Φ25
	2241/0322	Coupling nut for Lock - Φ32

Product Fact Sheet



Syngineering Water Pty Ltd
Ph: 1300 662 326
E: info@syngineering.com.au
W: www.syngineering-water.com.au